



# INSTRUCTION BULLETIN

No. DM20100  
Machine: os3  
Published: 05-2015  
Rev. 00

**NOTE: DO NOT DISCARD the Parts List from the Instruction Bulletin. Place the Parts List in the appropriate place in the machine manual for future reference. Retaining the Parts List will make it easier to reorder individual parts and will save the cost of ordering an entire kit.**

Installation instructions for kit number AT20045 / AT20046 - Use same procedure for assembling both kits



## PROTECT THE ENVIRONMENT

Please dispose of packaging materials, used machine components such as batteries and fluids in an environmentally safe way according to local waste disposal regulations.

Always remember to recycle.

1. Connect either the elbow fitting or straight fitting to the Portable Dispensing Unit (PDU) per application needs.

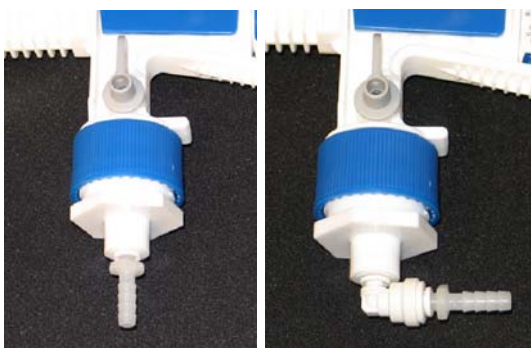

2. Connect the hose to the barbed fitting installed on the PDU in the previous step.



3. Trim the hose to the desired length.

4. Connect the opposite end of the hose connected to the PDU to the cap.



5. Connect the cap to the filled transport container.



- Connect either the spray nozzle attachment or bottle fill attachment to the PDU per application needs.

Connect: Push on and twist 1/2 turn to lock.

Disconnect: Twist 1/4 turn to unlock and pull off.



- Connect the PVC hose to the cold water supply and PDU.



- Use the valve to adjust the PDU for either Orbio solution or water / rinse.

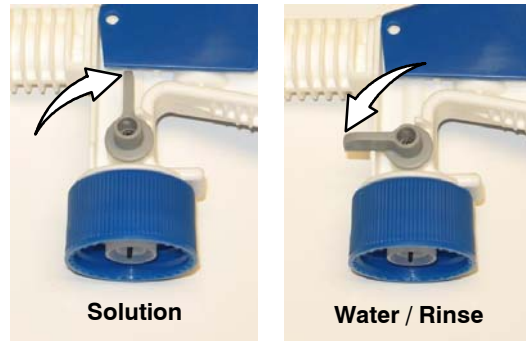

- Turn on water supply and depress PDU handle to dispense. For hands-free filling, use the locking trigger, forward to lock / back to unlock.
- Turn off water supply and disconnect hose after each use.

#### ORBIO PDU Optional Accessories



Spray Nozzle  
AS20125



Quick Connect  
AS20126



Back Flow Preventer  
AS20127



6 ft. Reinforced PVC  
Hose - AS20128



Transport Container:  
Multimicro Concentrate  
AT20045



Transport Container:  
Multisurface Concentrate  
AT20046

Note: Order Connection Kit AS20035 (MM) / Connection Kit AS20036 (MSC) to connect to os3 filler transport containers

TENNANT COMPANY  
P. O. Box 1452  
Minneapolis, MN 55440-1452